

THESE DRAWINGS ARE INSTRUMENTS OF SERVICE AND MAY NOT BE REPRODUCED, ALTERED, SOLD OR OTHERWISE DISTRIBUTED WITHOUT THE EXPRESS WRITTEN CONSENT OF GORDON HALL, ARCHITECT

# DESIGN PUBLICATION NOTES

THIS SECTION OUTLINES BASIC DESIGN ASSUMPTIONS AND OTHER GENERAL INFORMATION

- FOUNDATION LOGIC: THE ORIGINAL CONSTRUCTION WAS BUILT UPON A RECTANGULAR PILE GRID WHEREIN MUCH OF THE FOUNDATION WAS SUBMERGED IN WATER. IN ORDER TO MINIMIZE FOUNDATION WORK IN SUBMERGED AREAS, THE NEW DESIGN HAS BEEN DEVELOPED BASED ON A CANTILEVERED DECK CONCEPT WITH ESSENTIAL PILES STOPPING AT OR NEAR THE WATER'S EDGE. THE PILE GRID CONTINUES UPLAND TO PROVIDE REQUIRED BACKSPAN FOR THE MAIN DECK GIRDERS. THE OUTBOARD FOUNDATION SUPERSTRUCTURE IS ESSENTIALLY "TRUSSED" WITH PAIRS OF KNEE BRACES GUSSETED TO THE PILES. THE BENCHMARK STRUCTURAL DISTANCE FROM THE EDGE OF WATER PILE LINE TO THE OUTERMOST EDGE OF DECK FLOOR SURFACE IS 10'-2" - WHICH THE DESIGN TEAM HAS ESTABLISHED AS A MAXIMUM PRACTICAL DIMENSION TO BALANCE THE VIEWING EXPERIENCE WITH SITE CONDITIONS AND MATERIAL LIMITATIONS.  
THE CONTRACTOR'S LOGISTICAL REVIEW MAY CONCLUDE THAT THE WATERSIDE PILE LINE MUST STOP FURTHER AWAY FROM THE WATER'S EDGE IF AVAILABLE TECHNOLOGY IS DEEMED TO BE A LIMITING FACTOR. THE 10 FOOT DIMENSION MAY NOT BE INCREASED TO COMPENSATE FOR A RETREATING FOUNDATION LINE. IN THE EVENT THAT SAID PILE LINE MUST MOVE UPLAND IN EXCESS OF 3 FEET FROM THE LOCATION SHOWN ON THE DRAWINGS, ADDITIONAL DESIGN CONSIDERATION MAY BE REQUIRED. CONTRACTOR SHALL MAKE ARCHITECT AWARE OF SUCH CHALLENGES IF ADDITIONAL DESIGN CONSIDERATION IS REQUIRED.
- PILE GRID HAS BEEN DESIGNED WITH TREE PRESERVATION IN MIND. PARALLEL GIRDER LINE / PILE SPACING MAY NEED MODIFICATION IF IT IS DETERMINED THAT FOUNDATION INSTALLATION WILL CAUSE INJURY TO TREES NOT DESIGNATED FOR REMOVAL. GENERAL CONTRACTOR WILL NEED TO PERFORM A LOGISTICAL REVIEW OF SITE CONDITIONS AND REPORT ANY PROBLEM AREAS TO THE ARCHITECT IF DESIGN MODIFICATION IS REQUIRED DO TO LOGISTICAL LIMITATIONS.
- ONE TREE DOCUMENTED ON THE SURVEY HAS BEEN IDENTIFIED FOR REMOVAL IN THIS DESIGN LAYOUT. IF CONTRACTOR'S LOGISTICAL REVIEW CONCLUDES THAT THE REMOVAL OF THIS TREE IS NOT NECESSARY, THEN IT SHOULD NOT BE REMOVED. CONVERSELY, IF THE CONTRACTOR'S LOGISTICAL REVIEW CONCLUDES THAT ADDITIONAL TREES SHOULD BE CONSIDERED FOR REMOVAL FOR ANY REASON, THOSE RECOMMENDATIONS WILL BE EVALUATED TO DETERMINE IF THE DESIGN CAN BE MODIFIED TO SAVE THEM. ACCOMMODATION HAS BEEN MADE IN THE FRAMING PLAN FOR THE REMAINING TREES TO COEXIST WITH THE DECK ASSEMBLY BY ALLOWING THEM TO GROW THROUGH THE DECK.
- ARCHITECT'S DIRECTIVE IS TO EMPLOY STAINLESS STEEL TO THE GREATEST EXTENT POSSIBLE - AND ESPECIALLY IN AREAS WHERE ROUTINE MAINTENANCE IS NOT PRACTICAL. ALL REQUIRED HARDWARE MAY NOT BE ACCOUNTED FOR IN THE CURRENT DRAWINGS BUT WILL BE PROVIDED IN THE FINAL CONSTRUCTION DRAWING RELEASE.
- CONDITIONS HAVE BEEN IDENTIFIED WHERE BOLTED AND STRAPPED CONNECTIONS ARE AT RISK OF BEING BURIED IN DIRT. AS A PREVENTATIVE MEASURE, SHORT TIMBER RETAINING FEATURES HAVE BEEN INCLUDED TO PREVENT DIRECT BURIAL OF METAL STRUCTURAL COMPONENTS.
- 42" HIGH GUARD RAIL AT RAISED CONNECTING BOARDWALK AND BIRD VIEWING PLATFORM IS SIMILAR TO PANELIZED GUARD CONSTRUCTION AT REPTILE PLATFORM BUT WITHOUT THE ANGLED ALLIGATOR REACH LIMITING FEATURE
- GRADE LEVEL DECKING HAS NOT BEEN DETAILED. THIS TYPE OF "BOARDWALK" DETAILING IS UBIQUITOUS AND SHOULD NOT REQUIRE STRUCTURAL DOCUMENTATION. HOWEVER, THE PLAN WILL BE STUDIED AND ANY NON-STANDARD CRITICAL PATH ITEMS RELATING TO MISCELLANEOUS DECKING WILL BE PROVIDED.
- THE DESIGN OF THE NEW INFORMATION KIOSK HAS NOT BEEN FINALIZED. FOR PRICING PURPOSES, THE NEW DESIGN WILL BE SIMILAR IN SCALE AND GENERAL COMPOSITION TO WHAT IS EXISTING.
- ARCHITECT WILL ISSUE DESIGN UPDATES AS REQUIRED FOR CLARIFICATION OR WHERE THE NEED FOR DESIGN CHANGES ARISES.
- PARKING AND WALKING PATH GRADING SUBJECT TO ONGOING STUDY.

## FINISHED DECKING MATERIALS

CONTRACTOR SHALL PROVIDE PRICING OPTIONS FOR THE FOLLOWING DECKING MATERIALS FOR OWNER CONSIDERATION AND APPROVAL. FASTENERS SHALL BE SUBMITTED FOR APPROVAL BY DESIGN TEAM

- 5/4X6 IPE WITH EXPOSED S.S. FASTENERS
- 5/4X6 STANDARD TREATED PINE DECKING WITH EXPOSED STAINLESS FASTENERS
- 2X6 "NO WANE" PT PINE DECKING WITH EXPOSED STAINLESS FASTENERS
- TREX BRAND THRU-BODY COLOR COMPOSITE 5/4 DECKING WITH EXPOSED FASTENERS INSTALLED PER MFR SPECIFICATIONS
- INCLUDE APPROPRIATE STAINS, WATER SEALS AND/OR TIMBER OILS IN PRICE AS APPROPRIATE TO MATERIAL.

## TREE PROTECTION AND EROSION CONTROL

CONTRACTOR SHALL PROVIDE SILT FENCE AND OTHER EROSION CONTROL BMPs CONSISTENT WITH LIMITING SITE DISTURBANCE AND POND SEDIMENTATION DURING CONSTRUCTION. CONTRACTOR SHALL PROVIDE PROTECTION FOR SPECIMAN TREES IN ADDITION TO PROVIDING PROTECTION FOR ESTABLISHED VEGETATION AROUND POND.

## VILLAGE ORDINANCES

CONTRACTOR SHALL MAINTAIN COMPLIANCE WITH ALL APPLICABLE VILLAGE ORDINANCES

## SEALED DOCUMENTATION

SEALED CONSTRUCTION DOCUMENTS WILL BE PROVIDED IN ADVANCE OF PERMITTING. FINAL DESIGN REVIEW AND DETAILING WILL CONTINUE DURING CONTRACTOR CONSIDERATION PERIOD. CONTRACTOR WILL RECEIVE ANY NOTEWORTHY REVISIONS RESULTING DURING THE FINAL DESIGN REVIEW PERIOD.

## LANDSCAPE PLANTINGS

LANDSCAPE PLANTING, IRRIGATION AND MULCHING ARE NOT INCLUDED IN THE GENERAL CONTRACTOR'S SCOPE UNLESS DIRECTED OTHERWISE BY THE ASSOCIATION

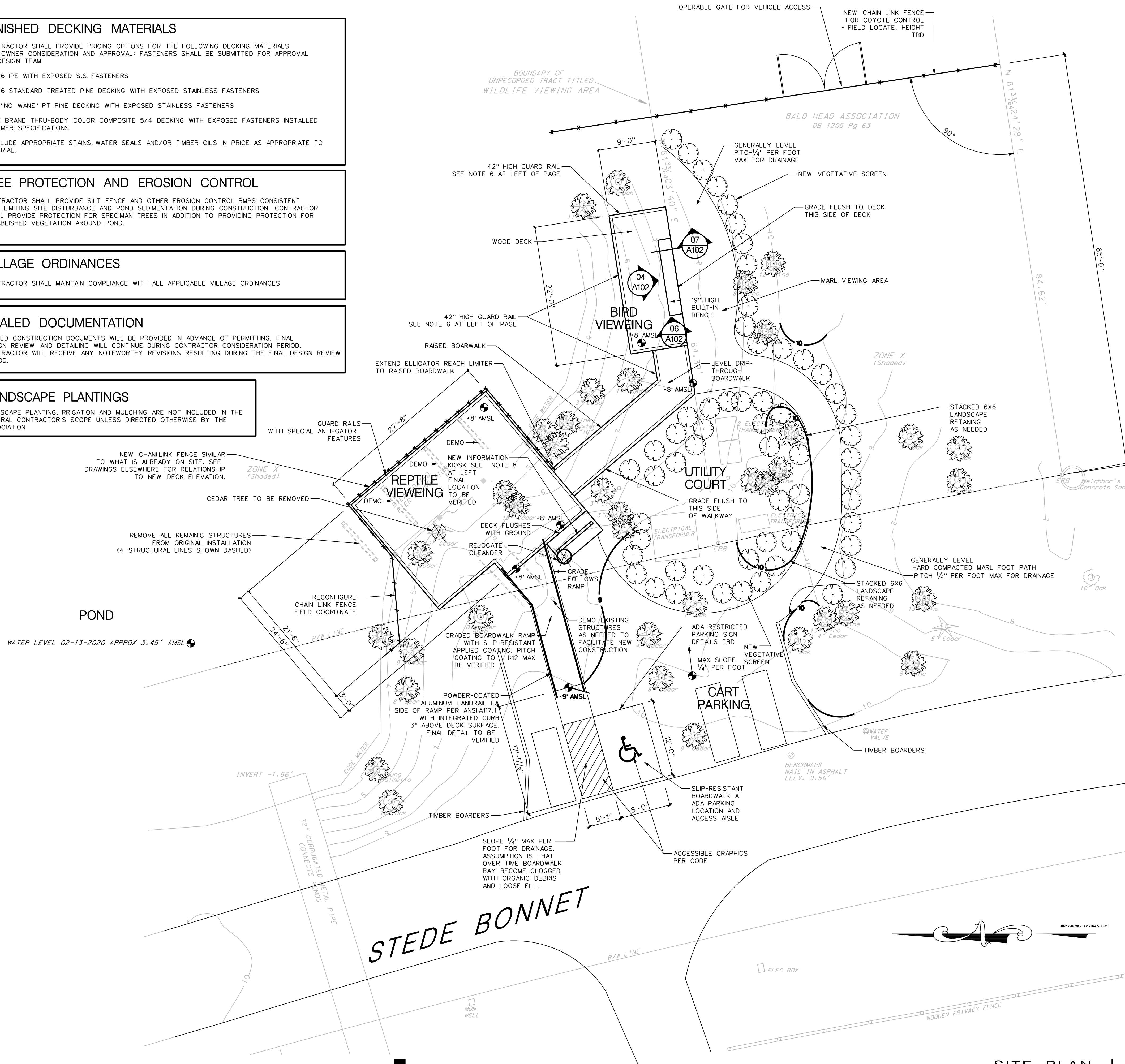

NOT FOR CONSTRUCTION  
WILDLIFE OVERLOOK

STEDE BONNET WYND, BALD HEAD ISLAND, NC  
GORDON HALL, ARCHITECT, PLLC  
2143 East Lake Shore Drive Wilmington NC PH 910-470-4255



ISSUE DATE  
PRELIMINARY PUBLICATION  
FOR CONTRACTOR  
ENGAGEMENT AND  
PRICING  
06 03 2020

STEDE BONNET

SITE PLAN

01

A101

SCALE 1/8" = 1'-0" (WHEN PRINTED AT 100%)

MAP CABINET 12 PAGES 1-9